

DEVELOPER

SBD PROPERTIES, LLP

8985 ROSEWOOD LANE  
MAPLE GROVE, MN 55369

MUNICIPALITY



PROJECT

THE BLUFFS OF  
RUM RIVER  
ST. FRANCIS, MN

ISSUE / REVISION HISTORY

DATE	ISSUE / REVISION	REVIEW
21 JULY 2022	CITY SUBMITTAL	CNC
10 AUG 2022	CITY SUBMITTAL	CNC

CERTIFICATION

IF THE SIGNATURE, SEAL OR FOUR LINES DIRECTLY ABOVE ARE NOT VISIBLE, THIS SHEET HAS BEEN REPRODUCED BEYOND INTENDED READABILITY AND IS NO LONGER A VALID DOCUMENT. PLEASE CONTACT THE ENGINEER TO REQUEST ADDITIONAL DOCUMENTS.



105 South Fifth Avenue  
Suite 513  
Minneapolis, MN 55401

Tel: 612-252-9070  
Fax: 612-252-9077  
Web: landform.net

FILE NAME: C201PLM003.DWG

PROJECT NO.: PLM21003

PHASING EXHIBIT

#1

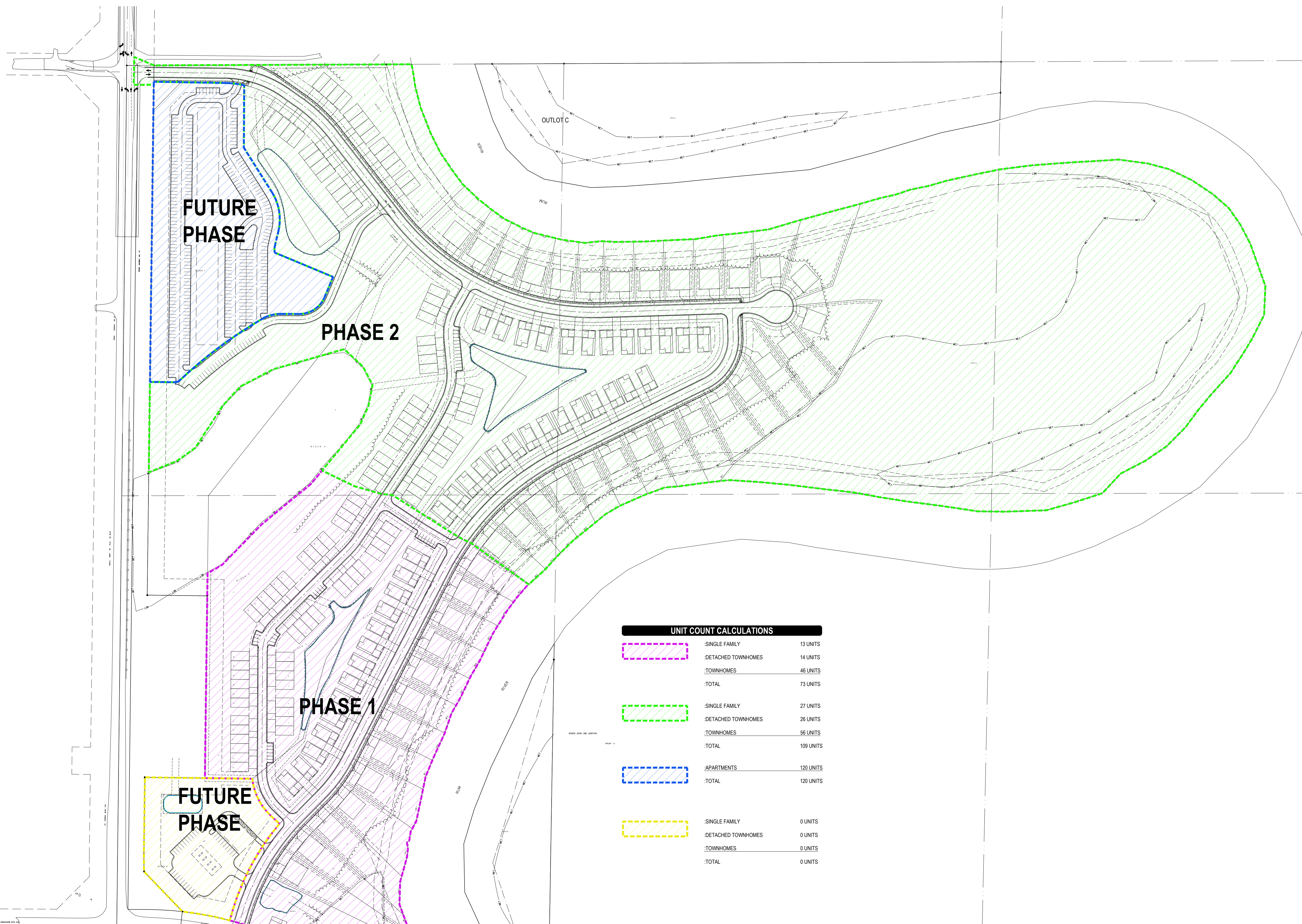

UNIT COUNT CALCULATIONS		
	:SINGLE FAMILY	13 UNITS
	:DETACHED TOWNHOMES	14 UNITS
	:TOWNHOMES	46 UNITS
	:TOTAL	73 UNITS
	:SINGLE FAMILY	27 UNITS
	:DETACHED TOWNHOMES	26 UNITS
	:TOWNHOMES	56 UNITS
	:TOTAL	109 UNITS
	:APARTMENTS	120 UNITS
	:TOTAL	120 UNITS
	:SINGLE FAMILY	0 UNITS
	:DETACHED TOWNHOMES	0 UNITS
	:TOWNHOMES	0 UNITS
	:TOTAL	0 UNITS



Know what's Below.  
Call before you dig.

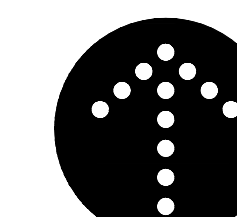

NORTH

