

Application Date:

Fee: \$120.00

CHICKEN PERMIT FORM
For Properties LESS than 5 Acres in Size

PROPERTY INFORMATION <small>If multiple properties, attach separate sheet</small>	PROPERTY ADDRESS		
	LOT SIZE <input type="checkbox"/> UNDER 2.5 ACRES <input type="checkbox"/> 2.5 TO 5 ACRES		
APPLICANT INFORMATION	NAME		
	PHONE	EMAIL	
OWNER INFORMATION. IF DIFFERENT THAN APPLICANT	NAME		
	ADDRESS		
	CITY	STATE	ZIP
	PHONE	EMAIL	

Responsibilities of property owners: by signing the permit below, you are agreeing to understanding and reading the Chicken Permit codes. City Code addresses the following:

- Properties less than 2.5 acres = no more than five (5) chickens
- Properties 2.5 to 5.0 acres = no more than ten (10) chickens
- 20 permits citywide will be allowed for properties less than 2.5 acres
- No roosters, no on-site butchering, no cockfighting, no infested coops or feed bins.
- Chickens must always be confined to a pen or run, and cannot be in the principal dwelling, garage, front yard or side yard.
- Permit holders cannot treat chickens in a cruel or inhumane manner
- Dead chickens must be disposed of according to the Minnesota Board of Animal Health rules which require chicken carcasses to be disposed of as soon as possible after death, usually within 48 to 72 hours.

REQUIRED MATERIALS – The following materials must be submitted in order to be considered a complete application.

- Chicken Permit completed and signed.
- Permit Fee of \$120, to be paid, once application is approved
- Scaled drawing (site plan) showing location, size, dimension of the coop & run. The site plan shall include:
 1. the proposed distances between the coop & run from neighboring homes
 2. proposed distances from other structures on the subject property,
 3. the property lines and the distances from them
- The maximum number of chickens to be kept on site
- A detailed waste removal plan addressing feces/manure and dead birds
- IF APPLICABLE – Signed authorization from property owner or Home Owner Association
- IF APPLICABLE - Electrical Permits shall be submitted to the State of Minnesota.

COOP AND RUN REQUIREMENTS

- Chickens must have BOTH a coop and run. A coop is the structure for the keeping & housing of chickens, and a run is a fully enclosed and covered area attached to a coop where chicken can roam unsupervised.
- Coops do not count towards a properties maximum accessory structure count
- All fencing, construction, electrical work, etc., must adhere to all applicable building and zoning codes, and all permits & licenses must be obtained.
- Chicken coops and runs must be at least 15 feet from side lot lines, and must be closer to the principal dwelling on the permitted property than to any dwelling on an adjacent property.
- Coops and runs must be 25 feet from wetlands, ponds, filtration/infiltration basins.
- Coops shall have a maximum footprint area of ten (10) square feet per chicken and a minimum footprint of five (5) square feet per chicken
- Runs shall have a maximum footprint area of twenty square feet per chicken, and a minimum footprint

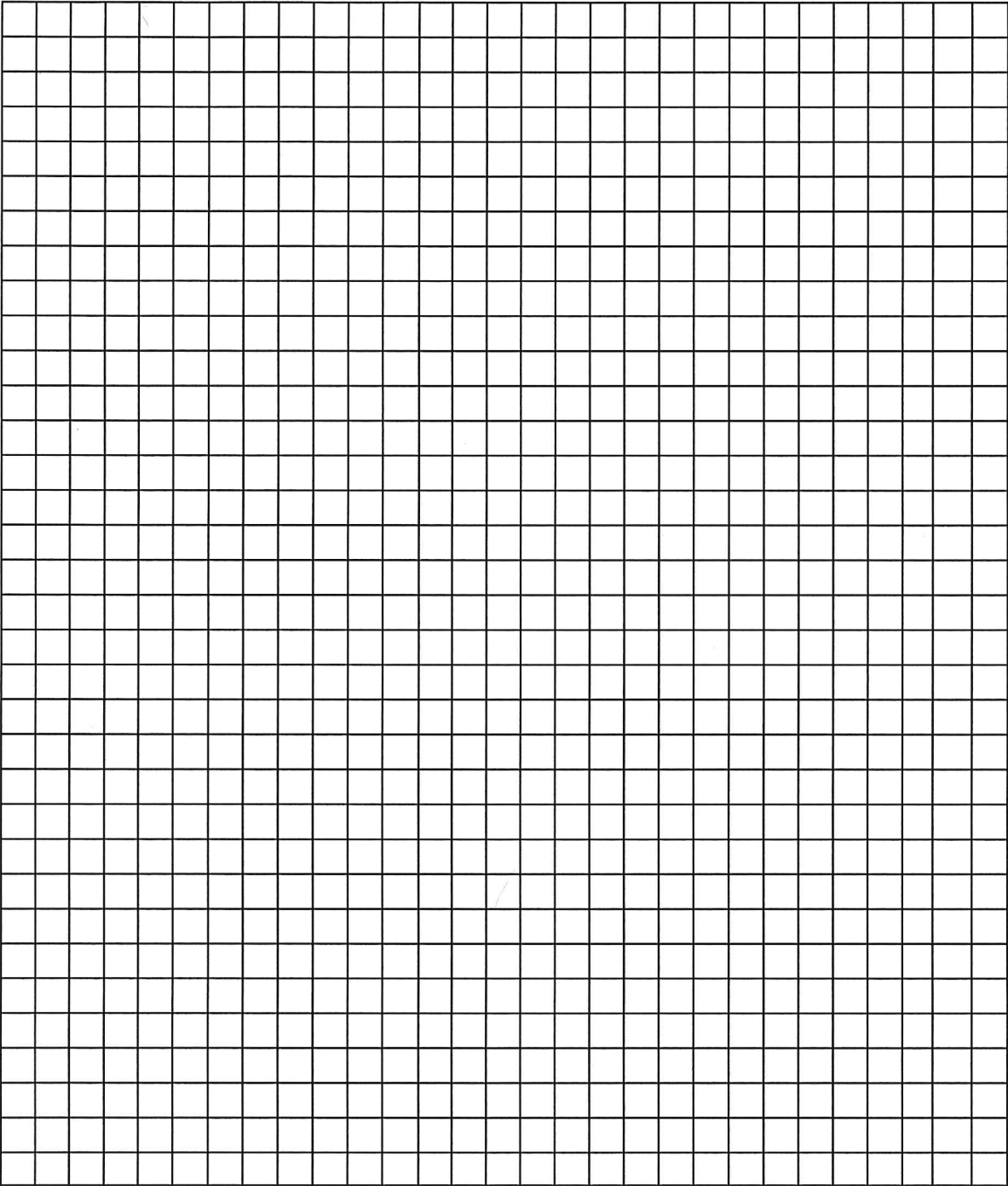

NORTH arrow required Scale: 1"= feet	SITE PLAN	DO NOT USE PENCIL
Site Address:	Legal Description (required):	
Owner's Name:		
<i>This site plan is an accurate and complete representation of the footprint(s) of all existing and proposed structure(s) and their location(s) on the subject property.</i> Applicant's Signature:		
Date:		

Example of site plan required for Chicken License

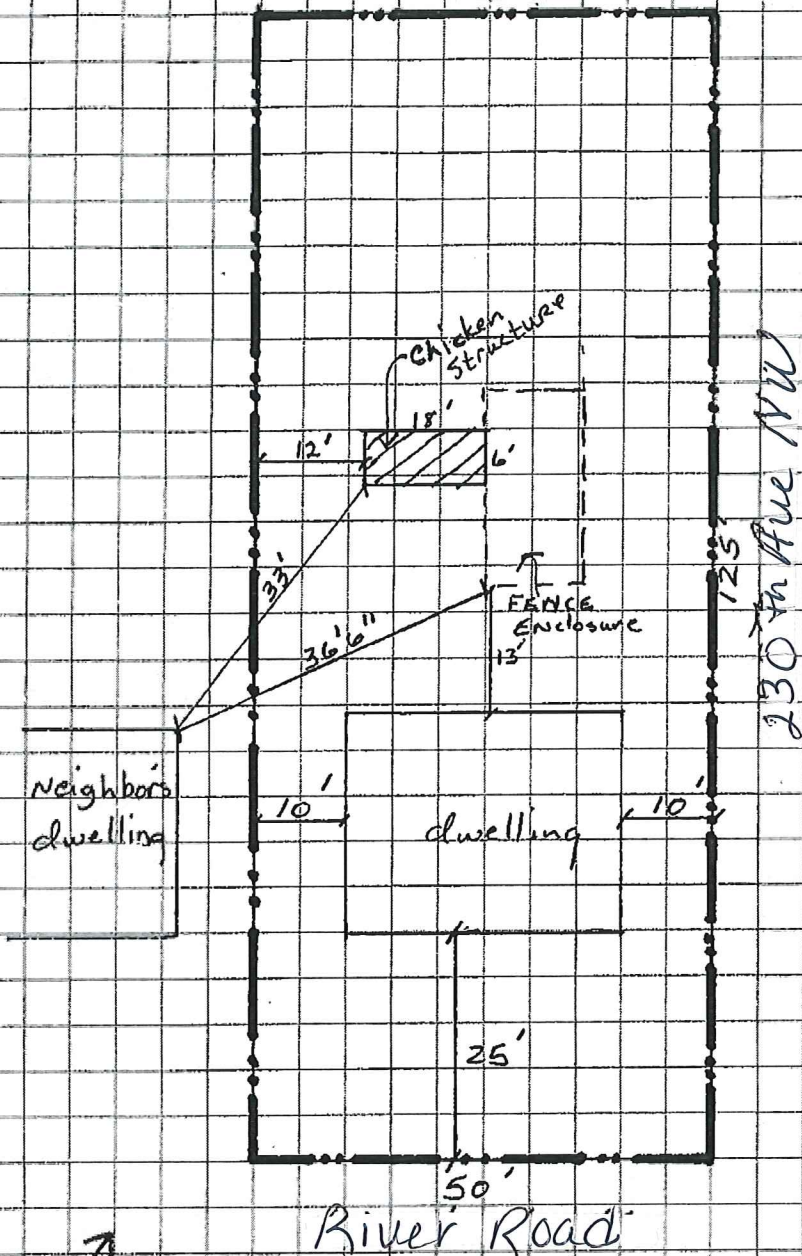

North arrow required
Scale: 1" = 20 feet

SITE PLAN

Grid is 4 squares per inch
DO NOT USE PENCIL

Site Address 23000 River Road

Owner's Name Jane Jones

This site plan is an accurate and complete representation of the footprint(s) of all existing and proposed structure(s) and their location(s) on the subject property

Applicant's Signature

Date

Legal Description

Required Lots 1

B/k 3 my town